

# Automate Your RAD/NUC Reachback Report

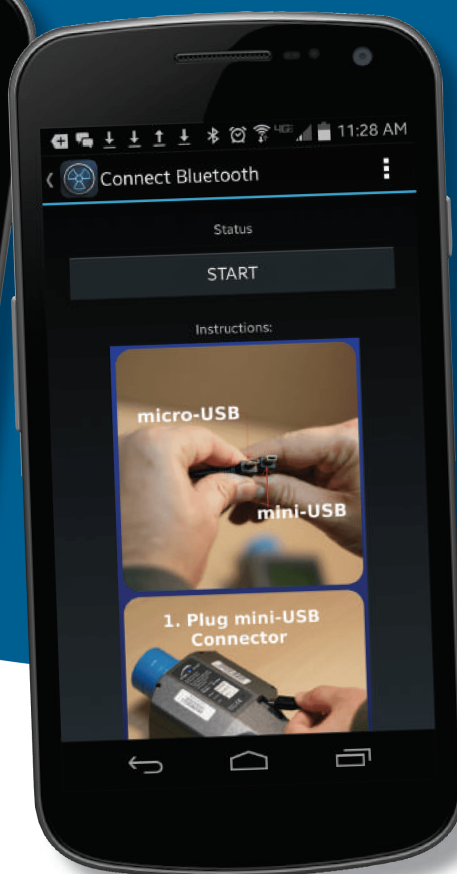

Save  
up to 90%  
compared to  
laptop based  
solutions.

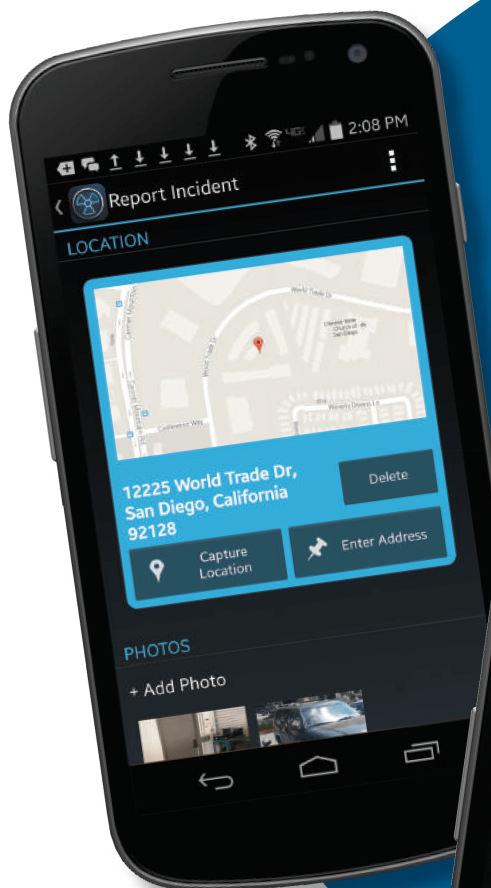

## RadMATE

The **RadMATE** app interfaces with Radiation Isotope Identifiers (RIIDs) to extract radiation spectra and create properly formatted Incident Reports. Send the Incident Report via **RadMATE** to your designated Analysis Center(s) for Reachback assistance. **Call today for more details.**

**Spectral Labs**  
Employee Owned

PHONE: 858.925.8237  
EMAIL: [radmate@spectrallabs.com](mailto:radmate@spectrallabs.com)

# RadMATE Makes Reachback Easy!

## PROVIDING YOU AN AUTOMATED SOLUTION:

- > Simple to learn and easy to use
- > Spectrum files recognized by analysis programs
- > Attach photos, videos and PDF/text
- > Includes Google map link to your immediate location (if desired)
- > Interface popular RIID and SPRD devices:
  - identiFINDER 1 & 2
  - GR-135
  - RadSeeker
  - ORTEC Detective Series
  - nanoRaider

Ask us  
about wireless  
hardware upgrades  
for legacy  
RIIDs!



## This App will help you ...

- > Adjudicate unknown/inconclusive gamma ray spectra
- > Simplify and expedite in-the-field Reachback
- > Minimize burden on operators
- > Eliminate need for costly laptops and aircard connections
- > Send consistent, complete and accurate Incident Reports

# RadMATE

